



HIGH OUTPUT COOKER & POT SET

Model No. CS2100



Suitable for outdoor cooking where larger pots and a higher heat output is required – Convenient for cooking sauces, crabs, lobster or any shell fish

Flame protection ring

Includes convenient carry case

Includes thermometer to achieve ideal cooking temperature

Pots are made from durable aluminium

Hose and regulator included

Propane/ULPG use only

Gas certified to Australia & New Zealand Standards



NOTE: USE OUTDOORS ONLY

Important: Retain these instructions for future use

Gasmate® is a registered trademark of

Sitro Group Australia Pty Ltd www.gasmate.com.au

Aber Living, N.Z www.gasmate.co.nz

03909 07/19

GENERAL WARNINGS

WARNING

- This appliance shall only be connected to a cylinder with a 3/8" LH cylinder valve certified to AS2469 standards.
- This appliance shall only be used with the Hose & Regulator Assembly supplied, Regulator is set to 95kPa and is not adjustable – Do Not Modify.
- This appliance is designed for outdoor use only and must be operated away from any flammable material or surfaces and materials.
- This appliance is to be stored in a dry and well-ventilated location free from direct sunlight.
- Do not store when appliance is still connected to the cylinder.
- Make sure that the cylinder is disconnected and is stored in a well-ventilated area, free from direct sunlight, heat and ignition sources.
- If being stored indoors, ensure that the location complies with the standard AS/NZS1596.
- This appliance must only be serviced by an authorised service agent, contact Sitro Group for assistance with repairs and spare parts.

DANGER

- During operation all surfaces will be extremely hot and should not be touched or handled.
- Do not use the appliance if it is leaking, damaged or does not operate properly.
- Handle with care even after brief use, always pick up using the legs not the cylinder.
- It may be hazardous to attempt to fit other types of gas containers or cartridges.
- Use only in well ventilated areas.
- Always operate appliance a minimum of 900mm from flammable materials, walls and 1200mm from the ceiling.
- Do not use adaptors. Do not modify appliance to fit other connectors or cylinders.
- Do not use multiple appliances to heat a single utensil.
- Children must be supervised by an adult at all times.
- Never leave appliance unattended when operating.
- Use as a cooking appliance only, not to be used as heater or modified for any other reason.
- Avoid boil over and spills on to burners.

CARBON MONOXIDE HAZARD

Using this appliance in an enclosed space may cause DEATH.

Do not use in caravans, tents, marine craft, cars, mobile homes or similar locations.

IMPORTANT

- Use outdoors only.
- Keep children away at all times.
- CAUTION: Accessible parts may be very hot. Please take care when handling or moving the appliance.
- Appliance is to be used on a stable, level, flat, non-flammable surface. The appliance should be protected from direct drafts and in a well ventilated place.
- Only cooking vessels with a minimum diameter of 200mm and a maximum of 300mm are to be used with this appliance.
- Take care that the primary air intakes, located on the burner tube of this appliance are not obstructed, or that air flow is restricted by placing items or other appliances close to or adjacent to the inlets.
- If you smell gas, immediately turn the gas off at the cylinder and move the appliance and cylinder to a well-ventilated area outside, keeping well away from sources of heat such as naked flames and pilot lights.
- Do not attempt to move or relocate the appliance when it is operating, extinguish the burner and allow to cool, disengage the gas cylinder then move the appliance.

PARTS LIST

CHECKING FOR GAS LEAKS

- Check that all connections are tight and that the gas cylinder connection has been tightened before you turn the cylinder gas valve on.
- NEVER check for leaks with a flame or pilot light.
- Using Companion Gas Leak Detection Spray or soapy water, coat all connections, if bubbles appear turn the cylinder gas control off and retighten the connection before re-testing.
- Inspect the appliance regularly for signs of wear, leaks or incorrect operation.

If symptoms such as flaring of the burner, issues with lighting, damages to hoses or connections or leaks from seals or gas controls are identified do not attempt to repair, return to your authorised stockist for service and maintenance.

CHANGING GAS CYLINDER

- To check if gas remains in the cylinder, disconnect from the appliance and hold the cylinder in a vertical position then shake from side to side, if there is a sound or feel of liquid movement inside, the cylinder contains gas.
- When changing gas cylinders ensure this is conducted outside in a well- ventilated location free from people, animals and ignition sources such as naked flames, pilot lights and electrical equipment with heaters or elements.



Part No.	Description	Qty
1	Steamer Pot	1
2	Boiler Pot	1
3	Burner Frame	1
4	Carry Bag	1
5	Hose and Regulator	1
6	Thermometer	1
7	Heat Reflector	1
8	Burner	1
9	Wing Nuts	2
10	Gas Valve Assembly	1

SAFETY INSTRUCTIONS

This appliance shall only be used in an above ground open air situation with natural ventilation without stagnant areas where gas leakage is rapidly dispersed by wind and natural convection.

Any enclosure in which appliance is used should comply with one of the following:

A. An enclosure with walls on all sides, but with no overhead cover.

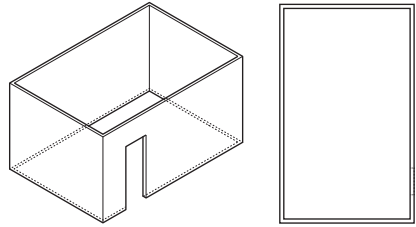

B. Within a partial enclosure that includes an overhead cover and no more than two walls.

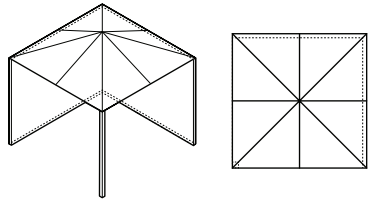

C. Within a partial enclosure that includes an overhead cover and more than two walls, the following must apply:

1. At least 25% of the total wall area is completely open.
2. 30% or more in total of the remaining wall side, back and front wall areas is open and unrestricted.
3. In the case of balconies, 20% or more of the total wall area must remain open and unrestricted.

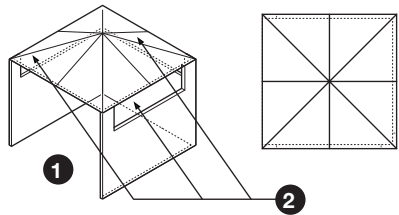
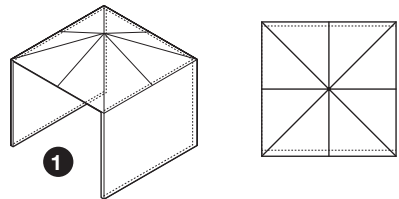

The figures shown are diagrammatic representations of outdoor areas. Rectangular areas have been used in these figures - the same principles apply to any other shaped areas.

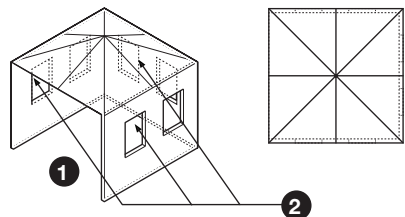

GENERAL ASSEMBLY

Connecting & Disconnecting to the Gas Source

Familiarise yourself with the general information and safety guidelines located in this manual. Note: Remove any transit protection material.

ASSEMBLY

Review the contents of the package. Make sure all listed components are included.

1. Install the burner and heat reflector into the steel frame, using the wing nut.

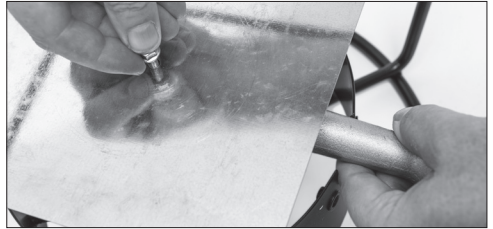
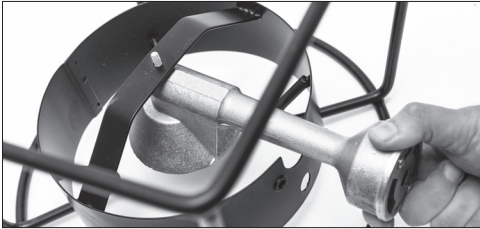

2. Align the Burner Tube Cover with the gas control assembly positioned at the end of the burner and then secure with the Wing Nuts.

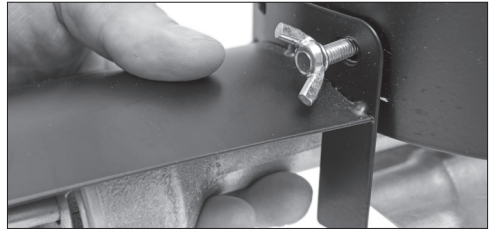
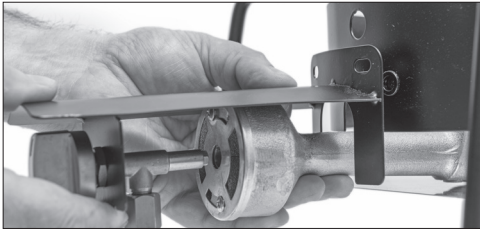

3. Attach the LP Gas hose to the Gas Valve Assembly using a spanner – Do Not Over Tighten.

CONNECTION

1. Check that the cylinder is filled, a sloshing sound will be heard when shaken.
2. Connect the Regulator to the cylinder valve and tighten (See Pic. A).
3. Connect hose to gas control and tighten with a spanner - take care not to overtighten (See Pic. B).
4. Check for any damage to either the cylinder connection or the hose. NEVER attempt to use damaged equipment.
5. Turn the gas cylinder valve on and spray soapy water on all connections to check for leaks. If a leak is detected turn the valve off, retighten all connections and retest.

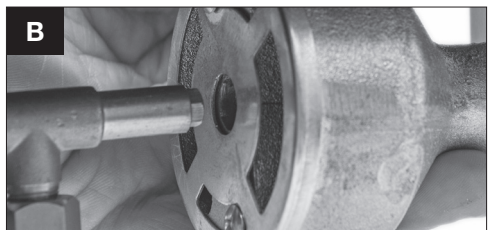

GENERAL ASSEMBLY

LIGHTING THE COOKER

1. Turn the gas cylinder valve on, in an anti-clockwise direction for one full turn.

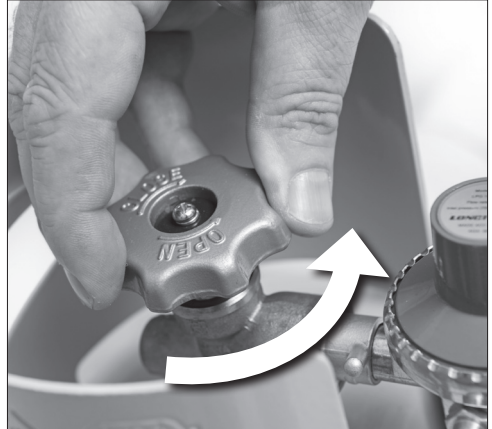

2. Using long BBQ matches or gas lighter, position close to the edge of the burner to be ignited, slowly turn the gas control in an anti-clockwise direction approximately 1/4 of a turn.

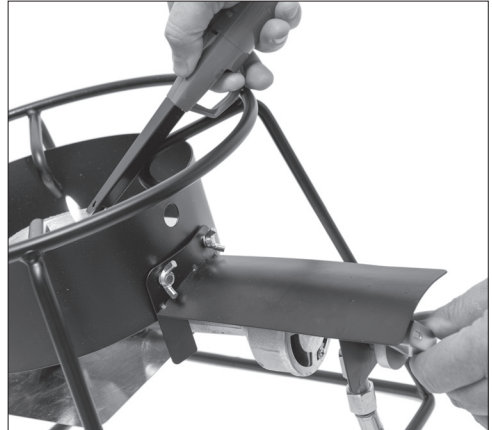

3. If the burner does not ignite, turn the gas control in the clockwise direction to the "OFF" position and allow the residual gas to disperse before attempting to reignite the burner.

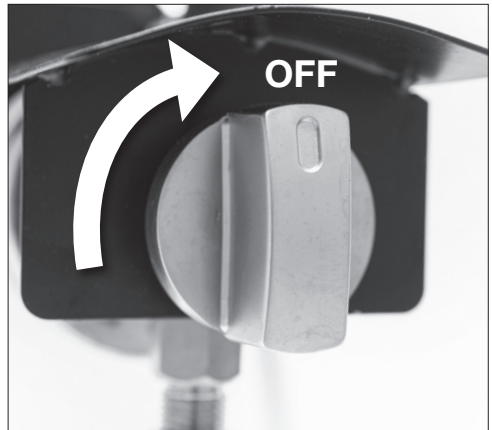

ADJUSTING HEAT OUTPUT

1. Turn the gas control in an anti-clockwise direction to achieve a higher flame and in the clockwise direction for a lower flame or to turn off.

Note: Locate the gas cylinder away from your cooker to ensure it is not subjected to radiant heat.

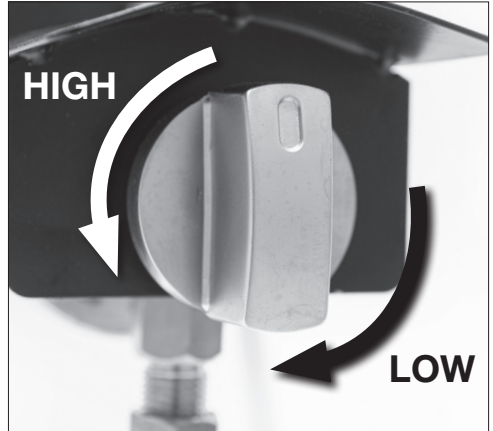

TURNING THE APPLIANCE OFF

If the appliance is no longer to be used and to reduce the risk of blocked gas jets caused by excess gas being left in the hose, all remaining gas must be expelled from the hose assembly.

1. With the flame still operating, turn the valve on the gas cylinder in the clockwise direction until it is off. Allow the flame to burn down then extinguish once all remaining gas in the hose has been used.

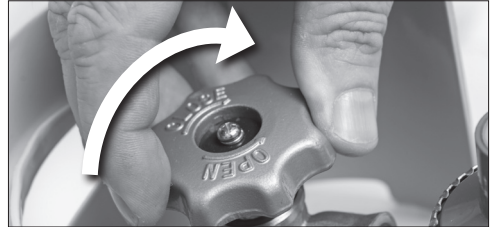

2. Turn the gas controls on the appliance clockwise to the "OFF" position.



STORING APPLIANCE

1. Wait for appliance to cool and disassemble all parts and place in pot.
2. Position frame over pot and allow to settle.
3. Place in storage bag.



CARE INSTRUCTIONS

As with all appliances, proper care and maintenance will keep them in top operating condition and prolong their life. By following these cleaning procedures on a timely basis, your appliance will be kept clean and working properly with minimum effort.

Using warm soapy water with a mild detergent wipe down all surfaces and areas of the appliance, taking care not to allow water to enter the burner outlets or aeration holes located in the burner tube.

DO NOT submerge the appliance in a sink or bowl.

DO NOT use abrasive cleaners or bleach.

SPECIFICATIONS

Model No.	CS2100	
Description	High Output Cooker & Pot Set	
Gas Type	Propane	ULPG
Injector	1.00mm	0.88mm
Pressure	150kPa	
Consumption	90 MJ/h 1786 g/h	78 MJ/h 1547 g/h
Certificate	AGA XXXX G	

MAINTENANCE & SERVICE

During operation if it is noted that the burner flame is unstable, is changing colour from blue to yellow or has a distinct smell it is important that you contact Sitro Group for your local authorised gas appliance repairer for inspection. Periodically check the gas control is tight and has no leaks, follow the testing for leaks procedure. Check the gas connection and regulator for any signs of wear or damage, if identified contact customer service for a replacement assembly immediately.

For further information or assistance please contact Customer Service on 1300 174 876 between the hours of Monday to Friday 8.00am – 5.00pm EST or email sales@sitro.com.au

For any queries or assistance call



Customer Service
Australia Only

1300 174 876

Hours of operation:
Monday to Friday 8.00am - 5.00pm EST

Do not return to place of purchase.

Keep your purchase receipt, this will be required to make any claims under the 12 month warranty.